

128,588 mm x 206,375 mm x 47,625 mm ISO  
799/792 tapered roller bearings

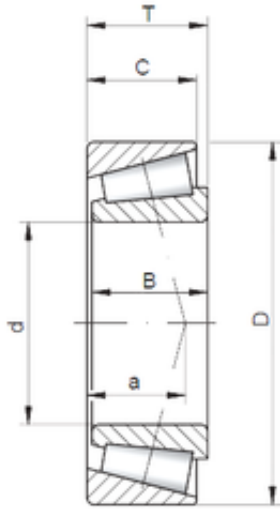

Bearing No. 799/792

Size	128.588x206.375x47.625 mm
Bore Diameter	128,588 mm
Outer Diameter	206,375 mm
Width	47,625 mm
d	128,588 mm
D	206,375 mm
T	47,625 mm
B	47,625 mm
C	34,925 mm
a	1,8 mm

799/792 Bearing 2D drawings and 3D CAD models